

RFC-1 WORK FORM (7-76)
 U.S. DEPARTMENT OF COMMERCE
 NATIONAL OCEANIC AND ATMOSPHERIC ADMINISTRATION
 RESEARCH FACILITIES CENTER
 MIAMI, FLORIDA

AIRCRAFT
N43RF
 FLIGHT NO.
820924I
 FLIGHT ID
63-82
 DATE
SEPT. 24, 1982
 ALTITUDE
18-24K

FLIGHT LOG

TAKE OFF (City or airport)

NZY

LAND (City or airport)

NZY

PURPOSE

NHRL ODW MISSION #2 ON HURRICANE OLIVIA

PROPOSED TAKEOFF TIME:	1830Z	PROPOSED FLIGHT DURATION:	9 HRS
TIME IN:	0340	TIME ON:	032745
TIME OUT:	1820	TIME OFF:	1830
BLK. TIME:	9, 3 HRS	FLIGHT TIME:	

FLIGHT PERSONNEL

OPERATIONS CREW		SCIENTIFIC CREW		VISITORS	
GUNNOE	CALVERT	HAYDU	STONE	BURPEE	
GENZLINGER		PARADIS		FRANKLIN	
NELSON		SCHRICKER		ADAMS	
RICCI		GOLDSTEIN		PARRISH	

PROPOSED MISSION

**SEE ODW DROP CHART
ON BACK OF THIS SHEET**

ACTUAL MISSION AND REMARKS

AS PLANNED

203330Z TO 231930 ADC NE (AP, BF ETC)

DATA COLLECTED AND REMARKS

SLOW

ODW

P/O

GOOD

BAD

INES, TO 1

A/C MANDER	NAVIGATOR	A/C NO.	MISSION NO.	TIME AIRBORNE	LOCATION	DATE	PROJ. NAME
Donnoe	NE/S	N60AA 43	820924	1830	N3242.1 W11712.0	24 Sept 82	Olivia

TIME OF ENTRY	POSITION	TYPE	INERTIAL POSITION	LAT LON COR'S	POSITION	LAT LON COR'S	REMARKS
182635	N3242.1 W11712.0	4	Same		Same		BK. KNZY 18
182944	N3242.6 W11712.6	4	N3242.5 W11712.7		N3242.5 W11712.7		Rwy 18 T/O KNZY
192731	N2910.1 W11753.3	6	N2910.1 W11752.2		N2909.4 W11752.2	F1 170	NE. Guadalupe. Abrean TH 184 RNG 21
193215	N2849.8 W11753.8	6	N2850.4 W11753.4		N2849.6 W11753.5		SE SAME. ON TH 182 RNG
211920		10	N2217.4 W12124.3		N2217.3 W12124.3		2048 T160 2104 FL200 INE# decoupled!
02434	N2910.0 W11755.8	6	N2911.5 W11751.6		N2908.6 W11752.7	F1240	2146 FL220 FL240 LON ~ 1.5nm ERROR. TH 06 RNG 19
03074	N3241.5 W11712.0	9	N3243.2 W11708.7		N3241.6 W11710.2		Ldg. KNZY
0341	N3242.2 W11712.0	4	N3244.0 W11708.4	-1.8 +3.6	N3242.6 W11710.2	-0.4 +1.8	1 1

SYS	BEGIN ALIGN TIME	NCS CONN	Ω AID	TIME OUT OF COARSE	ALIGN STS 0-5	(1) TIME INTO NAV.	(2) TIME OUT NAV.	ΔT (2)(1)	TERMINAL ERRORS		
				ELAPSE ALIGN POST TIME					LAT	LONG	GS
INS 1	1725	Y	OSC	—	0	1816	0341	9.4	-1.8	+3.6	1
INS 2 or IMU	1725	Y	"	—	0	1816	0341	9.4	-0.4	+1.8	1

ALIGN REMARKS :

OTHER REMARKS :

TYPE OF FIX : (1) DR (2) RADIO (3) CELESTIAL (4) VISUAL (5) LORAN
 (6) RADAR (7) DOPPLER (8) OMEGA (9) INERTIAL
 (10) OMEGA - INERTIAL

TIME	LAT	LONG	TK	WD	WS	RA	PA	TA	TD	PS	FWE	HT
	29.88		1010.9	→	1012	-5P		(55)88		PS	1011.3	
1834	32 51	117 35	227	170	9.7	1656	1609	20.2	11.9	830	-0.5	5872
1851	31 69	117 64	180	171	12.4	4858	4610	-0.2	-2.1	568.9	-1.0	5881
190527	30 66	117 69	188	176	20.4	4863	4606	0.3	-2.4	568.9	-0.1	5881
ODW	DROP #1		1 GOOD									
193000	28 96	117 88	183	178	22.0	5501	5229	0.2	-14.7	523.7	0.0	5872
ODW	DROP #2		1 GOOD									
194530	27 92	117 91	181	180	20.0	5502	5227	1.1	-14.4	523.9	-0.1	5875
195840	26 98	117 93	184	182	18.9	5499	5223	1.3	-13.7	524.2	0.0	5877
ODW	DROP #3		1 GOOD		2	BAD						
201600	25 75	117 98	182	181	13.3	5499	5220	1.9	-13.5	524.4	-0.1	5884
202735	24 98	118 04	229	182	11.7	5497	5218	1.1	-13.5	524.5	0.2	5882
ODW	DROP #4		1 GOOD		1	BAD						
204550	24 00	119 28	229	204	11.8	5487	5217	0.1	-8.0	524.7	0.2	5872
ODW	DROP #5		1 GOOD									
210600	22 98	120 56	226	242	5.5	6497	6158	-6.1	-18.3	461.6	0.0	5866
ODW	DROP #6		1 GOOD									
212500	22 01	121 78	264	216	3.5	6493	6157	-6.2	-19.5	461.2	0.1	5853
ODW	DROP #7		1 GOOD									
215000	22 00	123 91	268	217	7.5	7109	6738	-10.0	-21.6	425.9	-0.3	7593
ODW	DROP #8		1 GOOD									
220620	22 00	125 26	270	221	7.8	7101	6736	-9.8	-21.9	426.0	-0.4	7587
221655	21 99	126 15	269	208	6.4	7098	6734	-9.0	-21.6	426.1	-0.1	7585
ODW	DROP #9		1 GOOD									
223250	22 01	127 47	271	211	6.2	7093	6734	-9.2	-21.5	426.2	-0.1	7580
224345	22 02	128 41	270	212	8.5	7093	6732	-9.7	-21.5	426.3	0.6	7579
ODW	DROP #10		1 GOOD		1	BAD						
230844	22 05	130 50	002	230	8.4	7087	6731	-10.3	-21.5	426.4	1.4	7575
ODW	DROP #11		1 GOOD									
232410	23 41	130 47	001	230	10.4	7081	6731	-11.5	-23.3	426.7	0.0	7566
ODW	DROP #12		1 GOOD									
234050	24 86	130 50	358	190	9.0	7734	7347	-16.2	-25.2	390.9	-0.4	7561
ODW	DROP #13		1 GOOD									
235720	26 26	130 42	87	183.7	3.9	7737	7345	-16.5	-25.8	391.0	0.0	7565
ODW	DROP #14		1 GOOD									
001825	26 29	128 46	90	217	5.3	7737	7342	-14.6	-27.0	391.1	0.0	7568
ODW	DROP #15		1 GOOD									
003923	26 23	126 47	149	234	10.9	7741	7340	-12.2	-25.4	391.5	-0.4	7574
ODW	DROP #16		1 GOOD									
005600	24 98	125 68	152	252	8.0	7751	7340	-12.5	-25.4	391.3	-0.1	7583
ODW	DROP #17		1 GOOD		1	BAD						
011250	23 92	124 91	47	232	6.3	7757	7341	-12.9	-25.4	391.3	-0.5	7588
ODW	DROP #18		1 GOOD									
013100	24 96	123 59	50	210	8.0	7764	7340	-12.6	-24.6	391.3	-0.1	7596
ODW	DROP #19		0 GOOD		1	BAD						
014940	26 02	122 17	51	211	11.3	7766	7339	-12.7	-25.2	391.3	-0.3	7598
ODW	DROP #20		1 GOOD									
020810	27 08	120 69	51	212.5	12.1	7770	7338	-12.4	-25.0	391.4	0.1	7602
ODW	DROP #21		1 GOOD		1	BAD						
022610	28 10	119 23	52	224	12.8	7777	7338	-12.5	-25.0	391.4	0.3	7609
ODW	DROP #22		1 GOOD									
024257	29 14	117 86	007	204	14.8	7770	7329	-14.8	-25.8	391.8	0.0	7613
ODW	DROP #23		1 GOOD									
025940	30 72	117 66	005	208	20.0	7757	7329	-14.7	-24.6	391.9	-0.1	7604
ODW	DROP #24		1 GOOD									

ask 42 ter drop a #2 1st

30 40N 117 42W

2 29 00N 117 53W

3 27 00N 117 57W

4 25 00N 118 00W

5 24 00N 119 16W

6 23 00N 120 33W

7 22 00N 121 45W

8 22 00N 123 54W

9 22 00N 126 08W

10 22 00N 128 24W

11 22 00N 130 30W

12 23 24N 130 30W

13 24 50N 130 30W

14 26 15N 130 30W

15 26 15N 128 30W

16 26 15N 126 30W

17 25 00N 125 45W

18 23 50N 125 00W

19 24 53N 123 38W

20 25 57N 122 12W

21 27 02N 120 44W

22 28 05N 119 16W

23 29 00N 117 53W

24 30 40N 117 42W

NZY
MISSION #2 ON PARADISE
PROPOSED FLIGHT DATES
9 MI
032
1830

STONE
BURPEE
FRANKLIN
ADAMS
HARRIS

DROP CHART
OF THIS

PLANNED

ENDDATA

T+30

Planned Drop Points

1	30-40	117-42.0
2	29-00	117-53
3	27-00	117-57
4	25-00	118-00
5	24-00	119-16
6	23-00	120-53
7	22-00	121-45
8	22-00	123-54
9	22-00	126-08
10	22-00	128-24
11	22-00	130-30
12	23-24	130-30
13	24-50	130-30
14	26-15	130-30
15	26-15	128-30
16	26-15	126-30
17	25-00	125-43
18	23-50	125-00
19	24-53	123-38
20	25-57	122-12
21	27-02	120-44
22	28-05	119-16
23	29-00	117-53
24	30-40	117-42

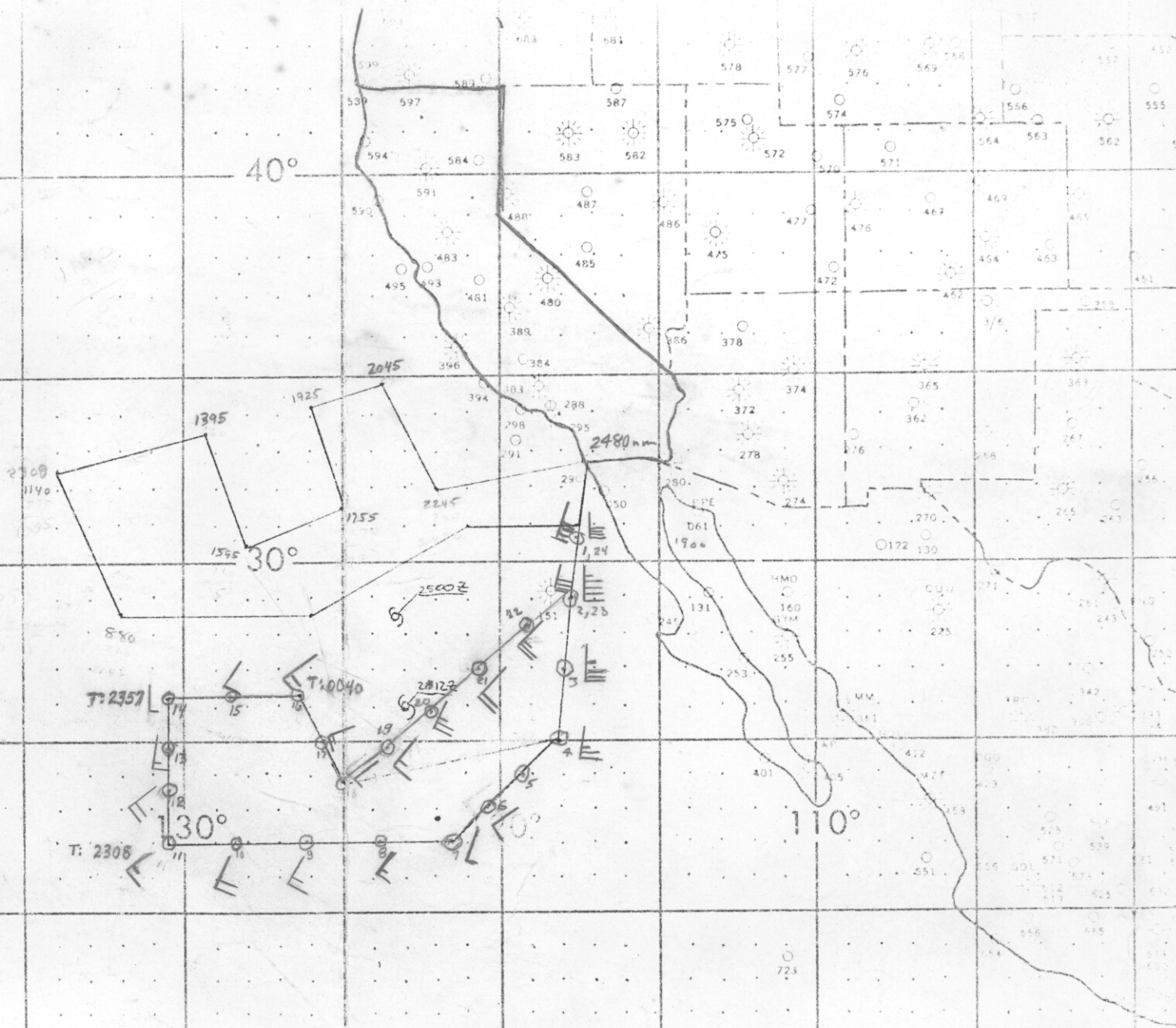

Flight Level Winds

8209241

T. OFF 1830