

# 19830817HI - LPS

Form E-1  
Page 1 of 5

## On-board Lead Project Scientist Checklist

DATE 8/17/83

AIRCRAFT 42RF

FLT 830817HI

A. Participants

ALICIA

| Function                 | Participant                 | Function            | Participant                 |
|--------------------------|-----------------------------|---------------------|-----------------------------|
| Lead Proj. Sci.          | <u>P. Black</u>             | Gust Probe          | <u>                    </u> |
| Cloud Physics            | <u>R. Black</u>             | Omegasonde          | <u>                    </u> |
| AXBT                     | <u>                    </u> | Sys Eng             | <u>R. Buslis</u>            |
| Hot Film                 | <u>                    </u> | Data Tech           | <u>A. JARVI</u>             |
| Radar                    | <u>GRIFFIN/DORST</u>        | EI Tech             | <u>                    </u> |
| Flt Dir/Met              | <u>Darby</u>                | Other               | <u>GUNNOE/Correll/NOBLE</u> |
| <u>John Thor DALBERG</u> |                             | Radio/NAV           | <u>CALVERT/NELSON</u>       |
| Take Off <u>0925Z</u>    | Location <u>MIA</u>         | Landing <u>1909</u> | Location <u>MSY</u>         |

### B. Past and Forecast Storm Position

| Date        | Time         | Latitude    | Longitude   | MSLP        |              |
|-------------|--------------|-------------|-------------|-------------|--------------|
| <u>8/17</u> | <u>06Z</u>   | <u>27.7</u> | <u>93.8</u> | <u>~991</u> | <u>70 kt</u> |
| <u>8/17</u> | <u>09Z</u>   | <u>27.9</u> | <u>94.0</u> | <u>985</u>  | <u>75 kt</u> |
|             | <u>1220Z</u> | <u>27.9</u> | <u>94.3</u> | <u>983</u>  | <u>85 kt</u> |
|             | <u>1325</u>  | <u>27.9</u> | <u>94.3</u> | <u>980</u>  | <u>85 kt</u> |
|             | <u>1414</u>  | <u>28.0</u> | <u>94.3</u> | <u>978</u>  | <u>90 kt</u> |

### C. Mission Briefing

Long term monitoring (p 22-23)

|  |             |             |             |            |              |
|--|-------------|-------------|-------------|------------|--------------|
|  | <u>1518</u> | <u>28.0</u> | <u>94.4</u> | <u>976</u> | <u>85 kt</u> |
|  | <u>1605</u> | <u>28.6</u> | <u>94.4</u> | <u>975</u> | <u>95 kt</u> |
|  | <u>1701</u> | <u>28.0</u> | <u>94.4</u> | <u>974</u> | <u>93 kt</u> |
|  | <u>1758</u> | <u>28.1</u> | <u>94.4</u> | <u>973</u> | <u>85 kt</u> |

D. Equipment Status

| <u>Equipment</u> | <u>Pre Flt</u> | <u>In Flt</u> | <u>Post Flt</u> | <u>Reports Collected</u> |
|------------------|----------------|---------------|-----------------|--------------------------|
| Aircraft         | ✓              | _____         | _____           | _____                    |
| Radar            | ✓              | _____         | _____           | _____                    |
| Cloud Physics    | ✓              | _____         | _____           | _____                    |
| Data Sys         | ✓              | _____         | _____           | _____                    |
| Omegasondes      | _____          | _____         | _____           | _____                    |
| AXBT             | _____          | _____         | _____           | _____                    |
| Gust Probe       | _____          | _____         | _____           | _____                    |
| Hot Film         | _____          | _____         | _____           | _____                    |
| Photography      | every 25.      | _____         | _____           | _____                    |
| _____            | _____          | _____         | _____           | _____                    |
| _____            | _____          | _____         | _____           | _____                    |

REMARKS

(notes p 2)

1540 2880m min 700 MB at from AF, 15Z

1606 eye clear from sea h/c to top, round clear center; oil rig in center

161317 oil rig below 70kt wind clear, green water streaming downwind from rig

161425 green water streaming 30° to right of ~~rig~~ <sup>wind</sup> 28, 34 93, 90

1620 2 new bands filling in S → E quad with 30mm spacing between eye wall and outer band at 100mm

1625 AF landing

1707 GULL 19 on station in eye at 1730

290  
1225  
90

E. Proposed and Actual Flight Patterns

notes P1



small inner eye - also reported by AF @ 07Z

1315 - AF coming in at 18k, 70 n. mi away GULL 19, GULL 11  
LF display washed out with STC on due later for NASA test

1321 eye clear above (obscured)

1410 983 w. 50 ht eye PMIN near NW wall old

1450 leg 4 - 2 cut short to 70 n. mi so we can get 15Z fix within window (no later than 30 min late)

1500 GULL 19 in center at 18k (training?)

1505  eyewall open NE, bearing W -> SW -> S

1514 AF slow dead ahead + directly above us heading W with us

1516 19 2 oil rigs directly below in eye, AF turning to right <sup>seg cab</sup>  
~~antenna~~ clockwise at edge of eye

E.1.3 Postflight

- \_\_\_\_\_ 1. Debrief crew.
- \_\_\_\_\_ 2. Report landing time, aircraft, crew and mission status to HRD operations center.
- \_\_\_\_\_ 3. Gather completed forms for mission and turn in at the operations center.
- \_\_\_\_\_ 4. Determine next mission status, if any, and brief crews as necessary.
- \_\_\_\_\_ 5. Notify operations center as to where you can be contacted.

notes p 3

- 171755, <sup>171900</sup> sea state six  $26 \text{ m s}^{-1}$   
1719 tail radar stopped sweeping - eye motor out  
1723 outer band in SE quad has moved W by  
20 n mi in  $5\frac{1}{2}$  hrs - abt same dist as eye  
1740 another oil rig below  
1757 AF C-130 in eye directly above  
1820 NHC forecasting 15" rain along coast  
2000 42RF will take off

122 8/16 + 48 28N 95W N

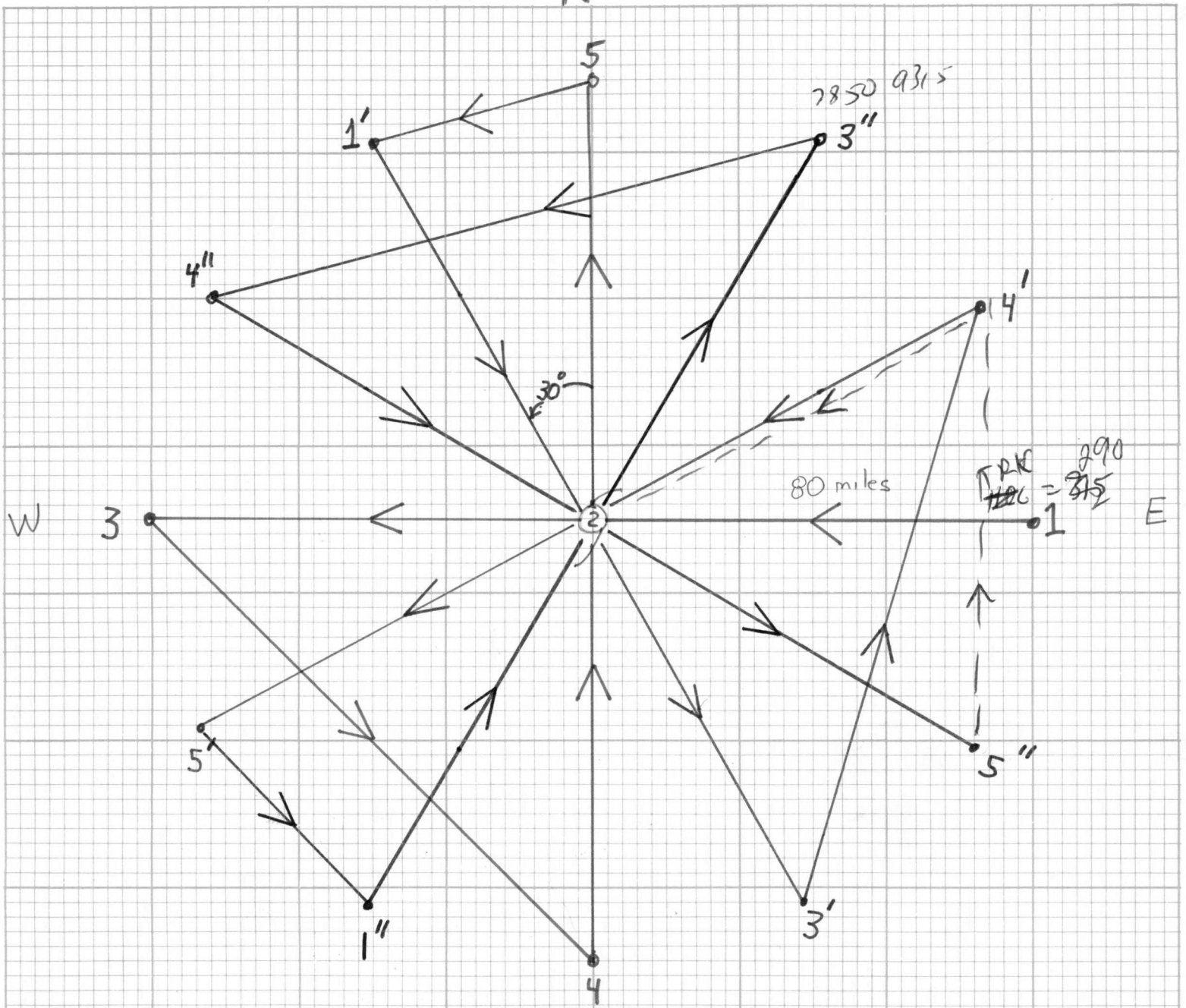

At 5000 ft RA  
S

- Fly 1-2-3-4-5-1'
- Fly 1'-2-3'-4'-2-5'-1''
- Fly 1''-2-3''-4''-2-5''

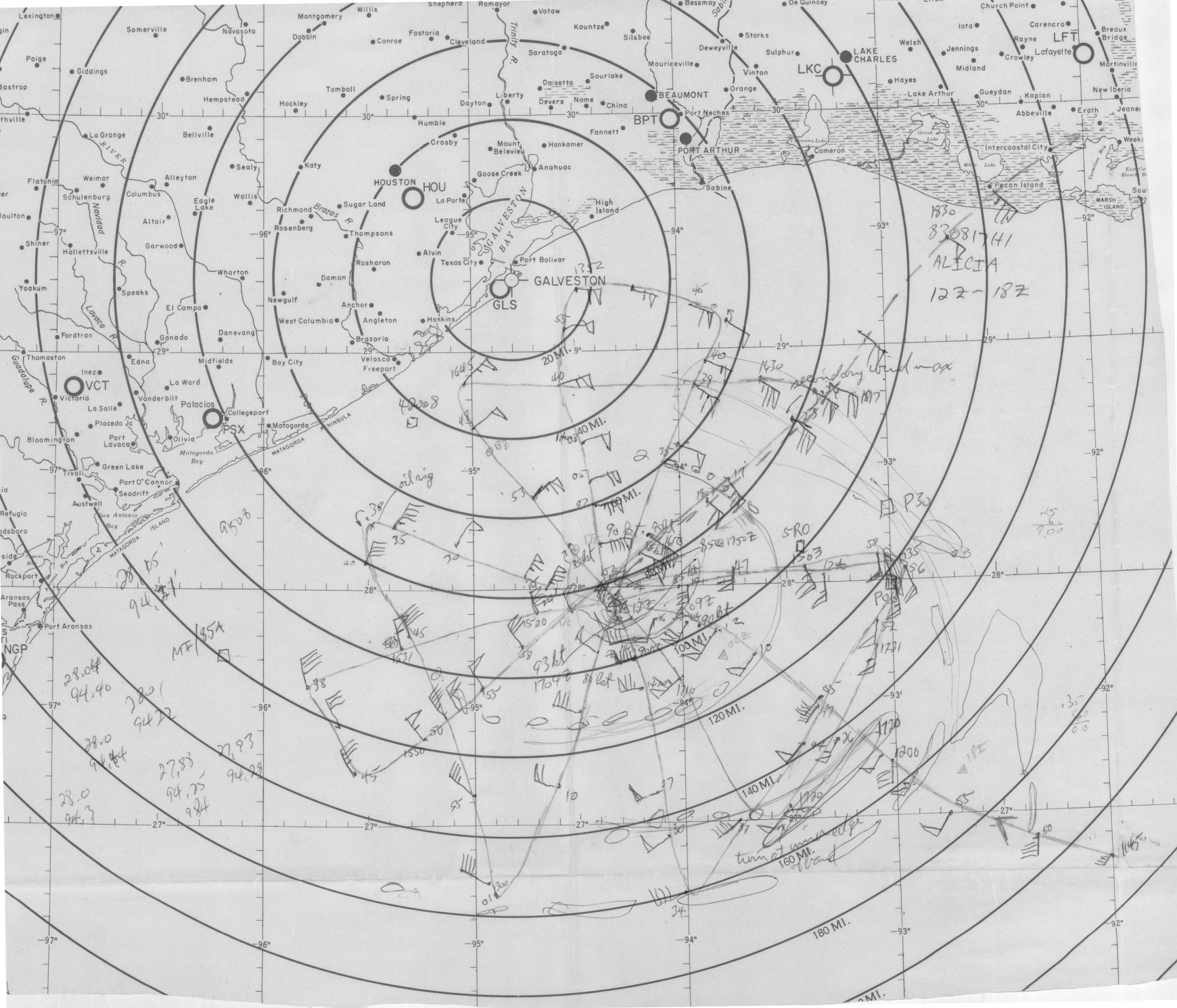

1830  
83081741  
ALICIA  
122-18Z

MF/35A

28.04  
94.40  
28.0  
94.22  
27.83  
94.20  
27.93  
94.22  
28.0  
94.3  
27.8  
94.2  
28.0  
94.3

turn at main edge  
of wind  
160 MI.

15  
6  
9.00

135  
6  
0.00

06Z, 17<sup>th</sup>

27°40' 93°47'

360° @ 30 mi: 70 kt ~993

1350 mi kt

closed eye  
mount 295° @ 5 kt

12Z 28.2 94.5

18Z 28.6 95.0

06Z landfall

closed eye C 20

Air Force - inner eye off + on

56 kt 070° 360° @ 60 m mi 997 mb

27°15' 92°45' @ 1746 Z 8/16  
27.2° 92.7

Mount 280°  $\frac{28}{6}$  ~ 5 kts

official

122 + 24 = 27.3 94.0  
+ 48 = 28.0 95.0

Gary

+ 24 27.4 94.9  
+ 48 28.1 97.3

Sheaton Lane  
2150 Veterans Blvd  
Kenner

---

+ 12 = 27.8 93.9  
182 + 24 = 28.7 95.0



Tues Aug 16

To: 092 = 09 PM

CREW LIST FOR ALICIA

To 092 = 5 AM

|          | <u>03, 06, 09</u> | <u>12, 15, 18</u>         | <u>21, 00, 03</u>                  | <u>06, 09, 12</u>  |
|----------|-------------------|---------------------------|------------------------------------|--------------------|
| Position | 43                | 42                        | 43                                 | 42                 |
| LPS      | Jorgensen         | P. Black                  | <del>B. Burpee</del> H. Willoughby | Jorgensen          |
| Doppler  | Lord              | --                        | Darby                              | --                 |
| Radar    | Goldenberg        | Griffin                   | Wiggert                            | Lord               |
| Radar    | Cheng             | <del>Franklin</del> Dorst | <del>Dorst</del> (NCAR)            | Cheng (Goldenberg) |
| Cld Phys | Willis            | B. Black                  | Bogert                             | Willis             |
|          | sk ft             | sk ft                     |                                    | ( — )              |

HRD is planning longer on authoring mission of TS Alicia  
commencing this evening

F T S

