

On-board Lead Project Scientist Checklist

DATE 8/17/83 AIRCRAFT 42RF FLT 830817H1
A. Participants ALICIA

Function	Participant	Function	Participant
Lead Proj. Sci.	<u>P. Black</u>	Gust Probe	<u> </u>
Cloud Physics	<u>R. Black</u>	Omegasonde	<u> </u>
AXBT	<u> </u>	Sys Eng	<u>R. Buslis</u>
Hot Film	<u> </u>	Data Tech	<u>A. Jarvi</u>
Radar	<u>GRIFFIN/DORST</u>	EI Tech	<u> </u>
Flt Dir/Met	<u>Darby</u>	Other	<u>GUNNOE/Correll/NOBLE</u>
John Thor <u>DALBERG</u>		Radio/NAV	<u>CALVERT/NELSON</u>
Take Off <u>0925Z</u>	Location <u>MIA</u>	Landing <u>1909</u>	Location <u>MSY</u>

B. Past and Forecast Storm Position

Date	Time	Latitude	Longitude	MSLP	
<u>8/17</u>	<u>06Z</u>	<u>27.7</u>	<u>93.8</u>	<u>~991</u>	<u>70 kt</u>
<u>8/17</u>	<u>09Z</u>	<u>27.9</u>	<u>94.0</u>	<u>985</u>	<u>75 kt</u>
	<u>1200Z</u>	<u>27.9</u>	<u>94.3</u>	<u>983</u>	<u>85 kt</u>
	<u>1325</u>	<u>27.9</u>	<u>94.3</u>	<u>980</u>	<u>85 kt</u>
	<u>1414</u>	<u>28.0</u>	<u>94.3</u>	<u>978</u>	<u>90 kt</u>

C. Mission Briefing

Long term monitoring (p22-23)

<u>1518</u>	<u>28.0</u>	<u>94.4</u>	<u>976</u>	<u>85 kt</u>
<u>1605</u>	<u>28.6</u>	<u>94.4</u>	<u>975</u>	<u>95 kt</u>
<u>1701</u>	<u>28.0</u>	<u>94.4</u>	<u>974</u>	<u>93 kt</u>
<u>1758</u>	<u>28.1</u>	<u>94.4</u>	<u>973</u>	<u>85 kt</u>

E.1.3 Postflight

- _____ 1. Debrief crew.
- _____ 2. Report landing time, aircraft, crew and mission status to HRD operations center.
- _____ 3. Gather completed forms for mission and turn in at the operations center.
- _____ 4. Determine next mission status, if any, and brief crews as necessary.
- _____ 5. Notify operations center as to where you can be contacted.

notes p 3

- 1717 55, ^{1719⁰⁰} No state fix 26 m s⁻¹
- 1719 tail radar stopped sweeping - az motor out
- 1723 outer band in SE quad has moved W by 20 n mi in 5 1/2 hrs - alt same dist as eye
- 1740 another oil rig below
- 1757 AF C-130 in az directly above
- 1820 NHC forecasting 15" rain along coast
- 2000 42RF will take off

290
1225 Z
90

Form E-1
Page 3 of 5

E. Proposed and Actual Flight Patterns

notes P1

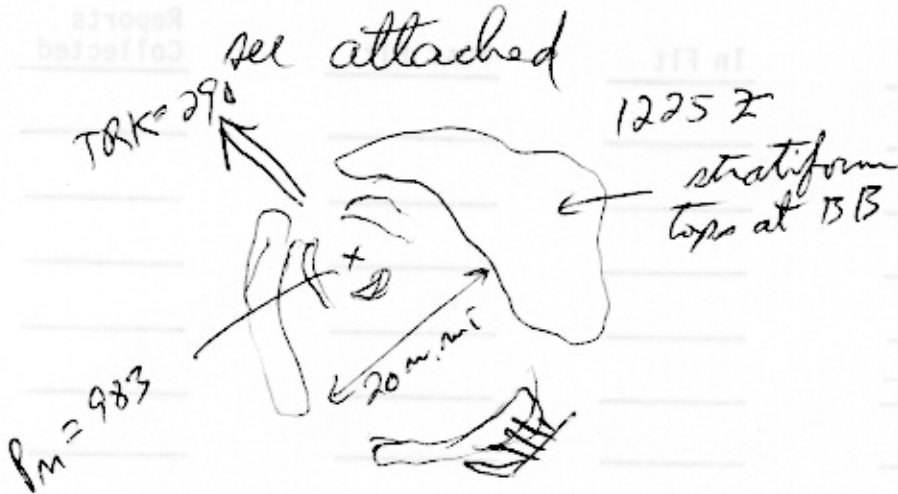

small inner eye - also reported by AF @ 07Z

- 1315 - AF coming in at 10k, 70 n. mi away GULL 19, GULL 11
LF display washed out with STC on due later for NASA test
- 1321 eye clear above (about)
- 1410 983 w. 50 ht ~~PMEN~~ near NW wall ed
- 1450 leg 4'-2 cut short to 70 n. mi so we can get 15Z fix within window (no later than 30 min late)
- 1500 GULL 19 in center at 10k (training?)
- 1505  eyewall open NE, heaviest W → SW → S
- 1514 AF down dead ahead + directly above us heading W with us
- 1516 19 2 oil rigs directly below in eye, AF turning to right ^{sec cab}
~~anticlockwise~~ clockwise at edge of eye

D. Equipment Status

<u>Equipment</u>	<u>Pre Flt</u>	<u>In Flt</u>	<u>Post Flt</u>	<u>Reports Collected</u>
Aircraft	✓			
Radar	✓			
Cloud Physics	✓			
Data Sys	✓			
Omegasondes	—			
AXBT	—			
Gust Probe	—			
Hot Film	—			
Photography	every 25.			
_____	_____	_____	_____	_____
_____	_____	_____	_____	_____

REMARKS

notes p 2

- 1540 2880 m min 700 MB at from AF, 15 Z
- 1606 eye clear from sea to top, round clear center; oil rig in center
- 161317 oil rig below 70 kt wind clear, green water streaming downwind from rig
- 161425 green water streaming 30° to right of ~~rig~~ wind 28, 34 93, 80
- 1620 2 new bands filling in S → E quad with 30 mm spacing between apex and outer band at 100 mm
- 1625 AF landing 62
- 1707 GULL 19 on station in eye at 1730

122 8/16 + 48 28N 95W N

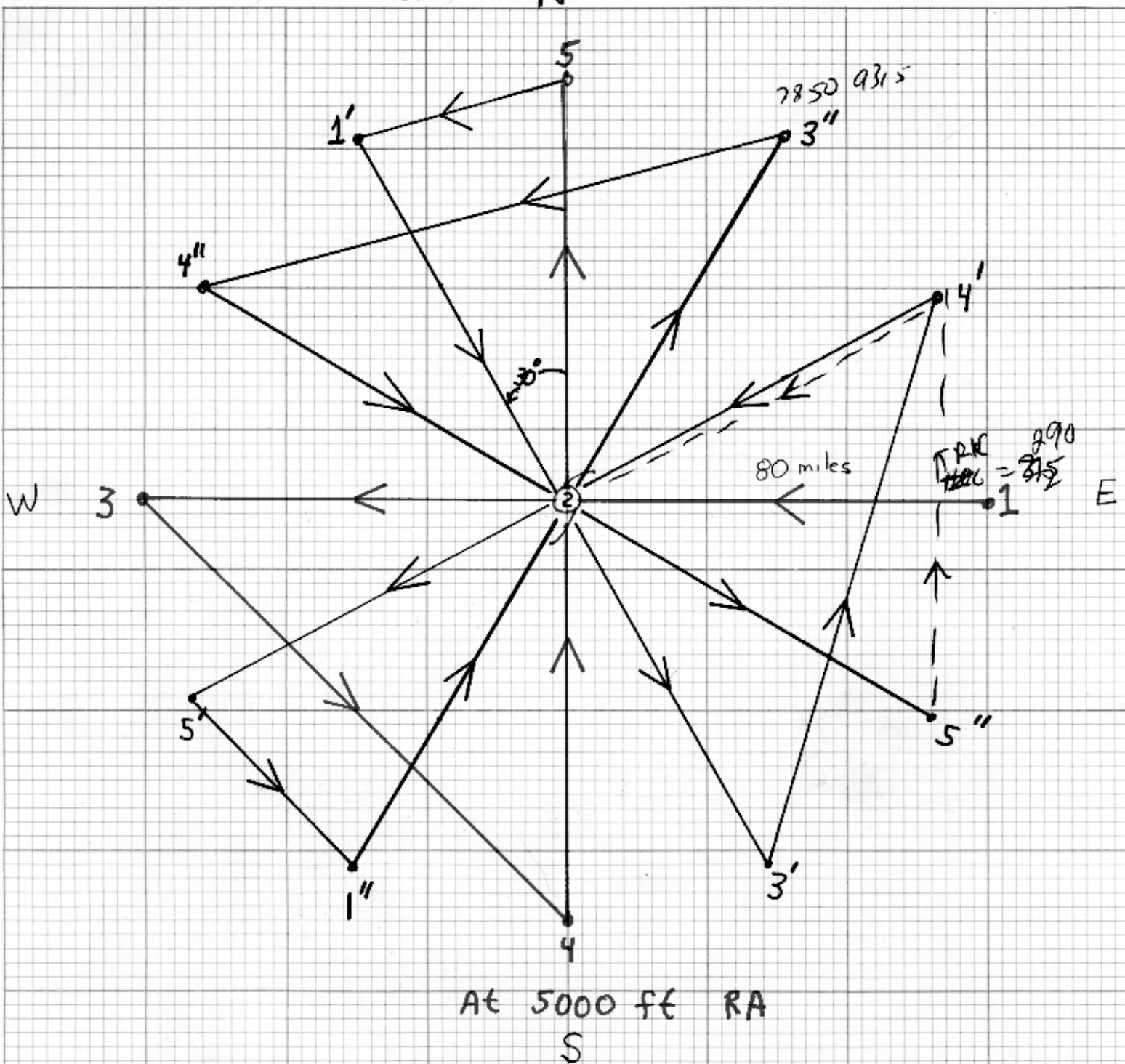

FLY 1-2-3-4-5-1'
 FLY 1'-2-3'-4'-2-5'-1''
 FLY 1''-2-3''-4''-2-5''

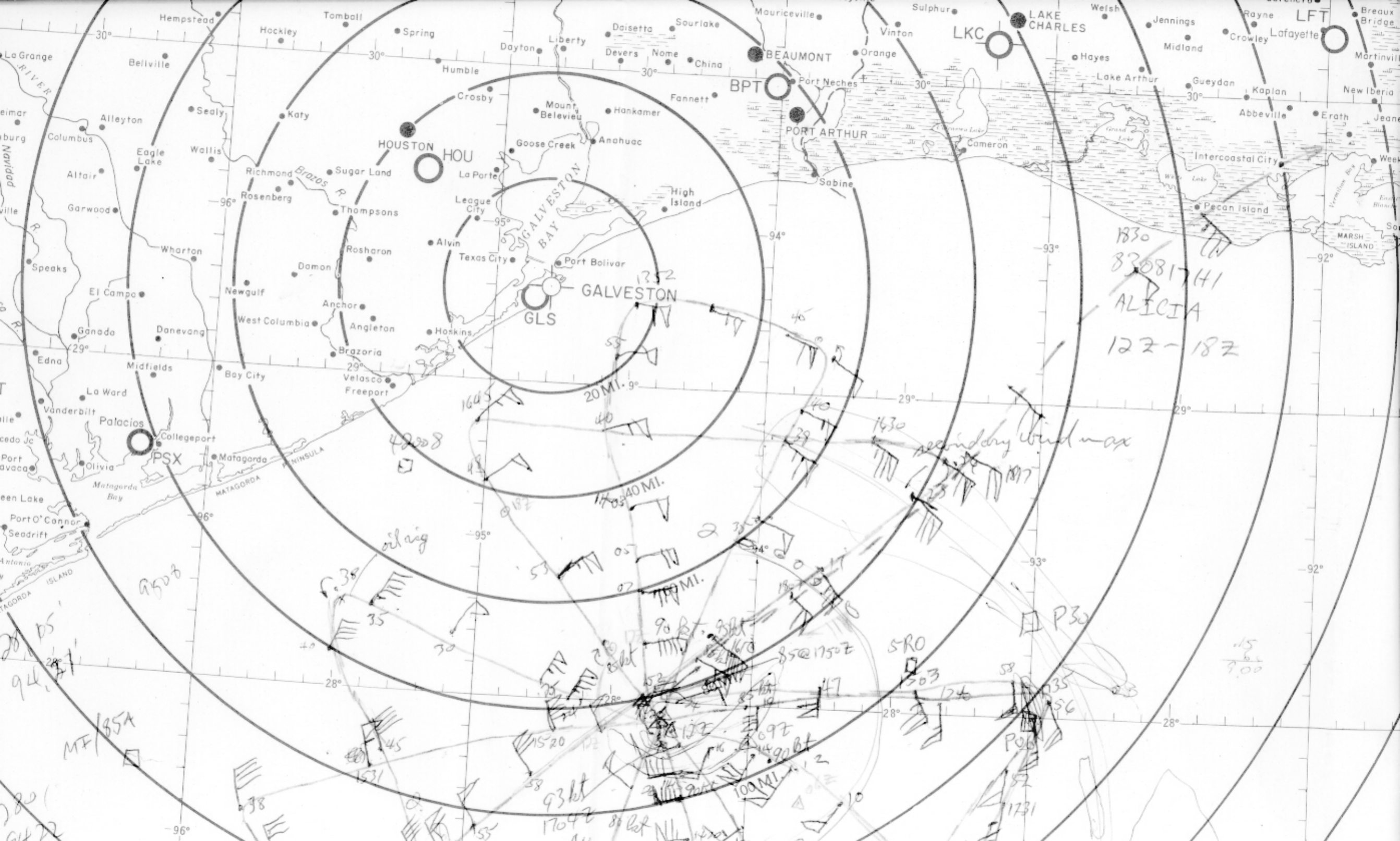

1830
 83081741
 ALICIA
 12Z-18Z

secondary wind max

oil rig

MF/BSA

15
 6
 9.00

9508

20 05
 28 37
 94 31

280
 64 22

20 05
 28 37
 94 31

20 05
 28 37
 94 31

20 05
 28 37
 94 31

20 05
 28 37
 94 31

20 05
 28 37
 94 31

20 05
 28 37
 94 31

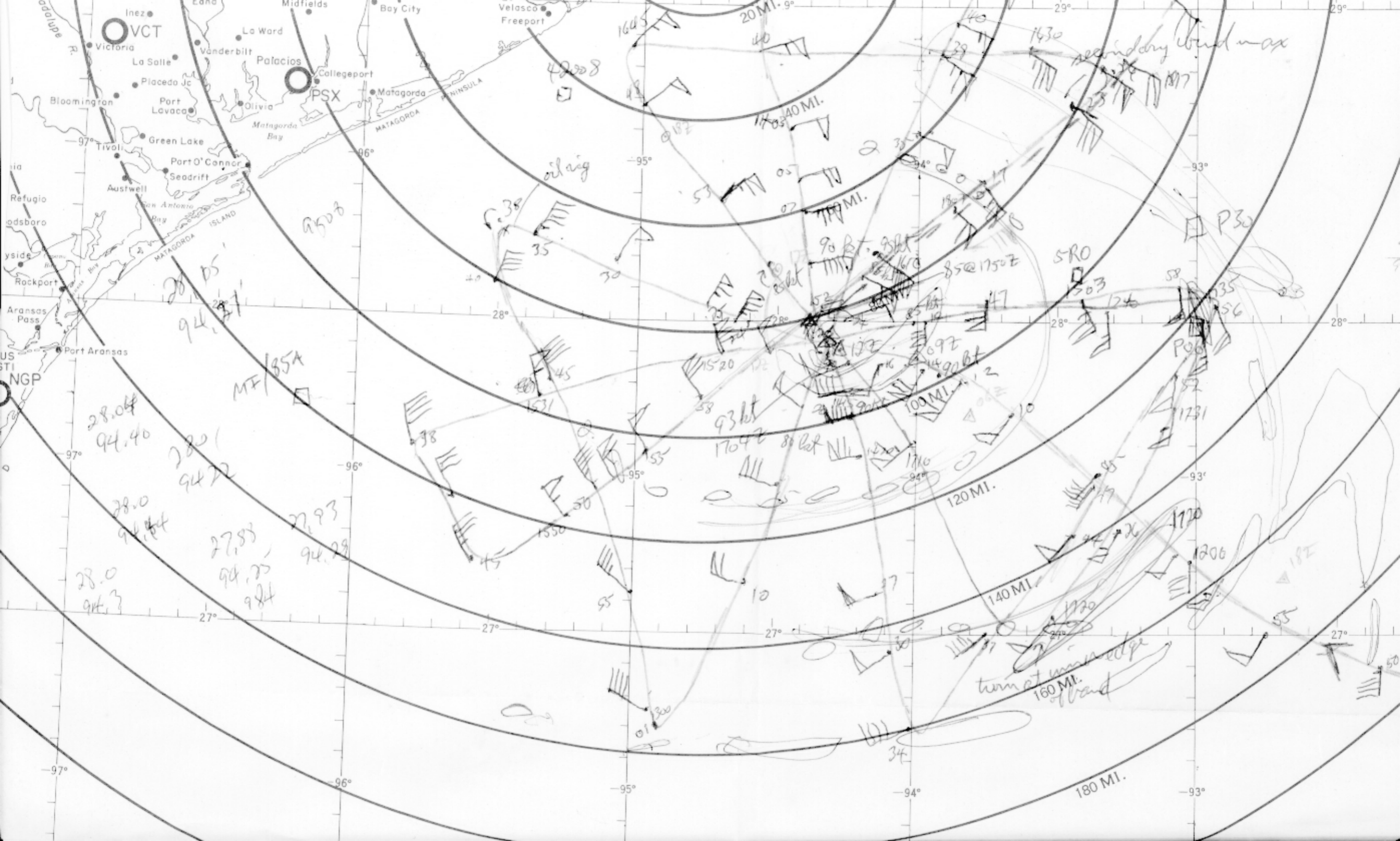

06Z, 17th

27°40' 93°47'

360° @ 30 mi 70 kt ~993

1350 mi AT

closed eye

mount 295° @ 5 kt

12Z 28.2 94.5

18Z 28.6 95.0

06Z landfall

closed eye C 20

Air Force - inner eye off + on

56 kt 070° 360° @ 60 m mi . 997 mbr

27°15' 92°45' @ 1746 Z 8/16

27.2° 92.7

Mount 280° $\frac{28}{6}$ ~ 5 kts

official

122 + 24 = 27.3 94.0

+48 = 28.0 95.0

Harry

+24 27.4 94.9

+48 28.1 97.3

Sheaton Lane
2150 Veterans Blvd
Kennebec

+12 = 27.8 93.9

182 +24 = 28.7 95.0

Tues Aug 16

To: 042 = 09PM CREW LIST FOR ALICIA
To 092 = 5AM

	03, 06, 09	12, 15, 18	21, 00, 03	06, 09, 12
Position	43	42	43	42
LPS	Jorgensen	P. Black	B. Burpee H. Willoughby	Jorgensen
Doppler	Lord	--	Darby	--
Radar	Goldenberg	Griffin	Wiggert	Lord
Radar	Cheng	Franklin Dorst	Dorst (NCAR)	Cheng (Goldenberg)
Cld Phys	Willis	B. Black	Bogert	Willis
	sk ft	sk ft		(—)

HRD is planning longer on anticyclone mission of TS Alicia
commencing this evening

FTS

